



## e-con Systems India Pvt Ltd

7<sup>th</sup> Floor, RR Tower - IV,  
Super A-16 & A-17, Thiru-Vi-Ka Industrial Estate,  
Guindy, Chennai - 600 032.  
[www.e-consystems.com](http://www.e-consystems.com)

### e-CAM30\_CUNANO



## Lens Datasheet

**Revision 1.3**  
17<sup>th</sup> Aug 2020



**Contents**

1	Revision History	3
2	Introduction	4
3	Disclaimer	4
4	Description	4
5	Optical Specifications	4
6	Mechanical Dimensions	5
	Support	6



## 1 Revision History

Rev	Date	Description	Author
1.0	23-Apr-2019	Initial draft	Camera Dev Team
1.1	17-Mar-2020	Updated new Lens Details	Camera Dev Team
1.2	01-June-2020	Updated Product Image	Camera Dev Team
1.3	17-Aug-2020	Document is made compatible with Jetson Xavier NX™ kit and updated product Image	Camera Dev Team



## 2 Introduction

The e-CAM30\_CUNANO board is a camera daughter board which is designed and developed by e-con Systems, a leading Embedded Product Design Services Company which specializes in the advanced camera solutions. e-CAM30\_CUNANO is 3.4 MP customer lens camera module based on 1/3" AR0330 CMOS image sensor from ON Semiconductor®. It is a color camera that supports uncompressed UYVY format. The e-CAM30\_CUNANO board is provided with S-mount (also known as M12 board lens) lens holder. The S-mount is the small form-factor lens mounts for board cameras.

e-CAM30\_CUNANO can be directly interfaced to the Jetson Nano™/Xavier NX™ development kit

This document describes the optical specification of lens used in e-CAM30\_CUNANO.

## 3 Disclaimer

e-con Systems reserves the right to edit or modify this document without any prior intimation or whatsoever.

## 4 Description

The lens used in e-CAM30\_CUNANO is a high resolution, 1/2.3" format, and wide-angle lens. It provides a maximum Field of View (FOV) of 118 degrees with 1/3" format AR0330 sensor.

## 5 Optical Specifications

The optical specifications of lens are listed in following table.

Description	Specification
Imager Format	1/2.3" (1/3" for AR0330)
Focal Length	3.0 mm
Aperture (F/#)	2.8
FOV	118°(D), 96°(H), 63.5°(V) (with 1/3" AR0330)
Distortion	< 35 %
Chief Ray Angle	< 16.5°

**Table 1: Optical Specifications of Lens**



## 6 Mechanical Dimensions

The mechanical dimensions of lens used in e-CAM30\_CUNANO is shown below.

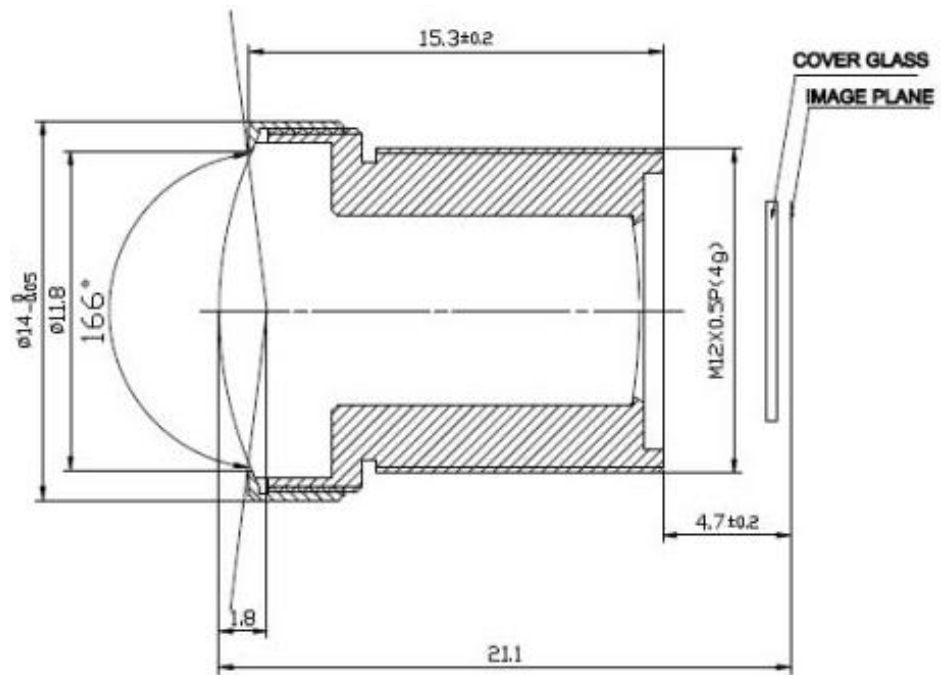

Figure 1: Lens Mechanical Dimensions

**Note:** All dimensions are in mm.



## Support

### Contact Us

If you need any support on e-CAM30\_CUNANO product, please contact us using the Live Chat option available on our website - <https://www.e-consystems.com/>

### Creating a Ticket

If you need to create a ticket for any type of issue, please visit the ticketing page on our website - <https://www.e-consystems.com/create-ticket.asp>

### RMA

To know about our Return Material Authorization (RMA) policy, please visit the RMA Policy page on our website - <https://www.e-consystems.com/RMA-Policy.asp>

### General Product Warranty Terms

To know about our General Product Warranty Terms, please visit the General Warranty Terms page on our website - <https://www.e-consystems.com/warranty.asp>

